

ABC HOMES - STOCK 118

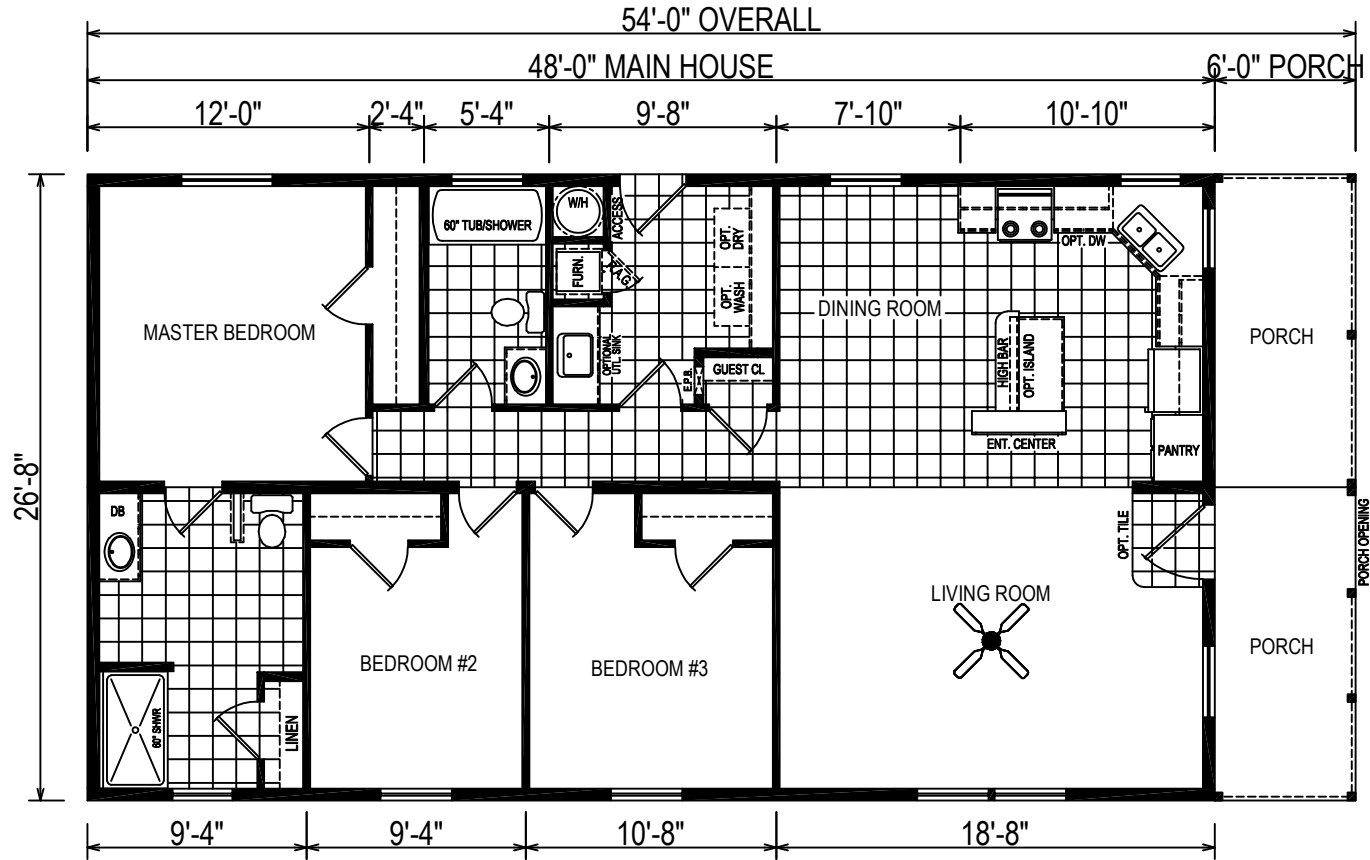

CD-52G906+6FTPORCH-28W

3 BEDROOM, 2 BATH

NOMINAL SIZE: 28'x52'

TOTAL AREA: 1,280 SQ. FT.

DUE TO CONSTANT PRODUCT IMPROVEMENT, ALL DIMENSIONS AND SPECIFICATIONS ARE SUBJECT TO CHANGE WITHOUT NOTICE OR OBLIGATION TO EAGLE RIVER HOMES. DIMENSIONS STATED ARE TO INDUSTRY STANDARDS. THE INFORMATION ON THIS PAGE IS PROPRIETARY AND CONFIDENTIAL.

CHESAPEAKE DOUBLE

EAGLE RIVER HOMES
THE INFORMATION ON THIS PAGE IS PROPRIETARY AND CONFIDENTIAL.

Revisions		Rev. Date:	Rev. By:	Date Drawn:	Title:	Serial No.:
A .		.	.	07-30-20	LITERATURE PLAN	-
B .		.	.			
C .		.	.	Drawn By:	Model:	Sheet:
D .		.	.	Y YD	CD-52G906+6FTPORCH-28W	LIT