

AT



OPT 48" SHOWER

OPT GUEST CLOSET



OPT S.G.D.

Shower
GFI

6'-8"

6'-8"

6'-8"

6'-8"

6'-8"

6'-8"

6'-8"

6'-8"

6'-8"

6'-8"

6'-8"

6'-8"

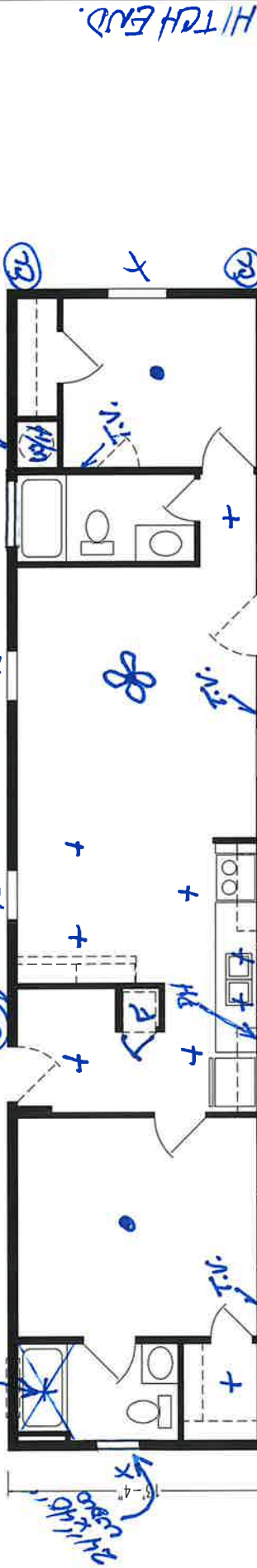

HITCH END.

DIVISIONS		REVISIONS		BOX LENGTH		DESCRIPTION	
231	SUGARCREEK	G	UPDATE TO NEWEST SPECS	10/20/22	RP		
233	ARKANSAS CITY	F	UPDATE LIGHT IN MSTR BDRM CLST	1/17/19	RS		
235	SAN JACINTO	E	UPDATE LIGHT IN MSTR BDRM CLST	7/12/17	SC		
237	WOODLAND	D	ENLARGE W/H CMPT, REFER OH, UPD BATH WINDOWS, BATH ELECTRICAL	6/11/15	KS	DRAWN BY:	RP
239	OCALA	C	REV KIT, HALL & DINING RM LIGHTS TO RECESSED CANS	1/23/15	KS	DATE:	01/20/22
X	241 LEOLA	B	UPD FLOOR W/DTH TO 160" ADD 39#	12/15/14	KS	ROOF ZONE	SMN
243	LANGASTER	A	REV TO W-101-A, UPD WINDOWS, GFI'S, HT RECEPT	9/18/14	KS	SHEET	1 OF 2
245	McMINNVILLE					DRAWING NUMBER	
		60'-0"		6014-2CK-2B		14-03539-06Q	

SKYLINE

DRAWN BY: RP

DATE: 01/20/22

SHEET 1 OF 2

DRAWING NUMBER 14-03539-06Q